

GLASS CORNER SHELF INSTALLATION INSTRUCTION

TO INSTALL THE SHELVES YOU WILL NEED A PAINTABLE ADHESIVE CAULKING, OR ANY COLOR AVAILABLE THAT IS SIMILAR TO YOUR WALL PAINT (WE DO SUGGEST AND/OR OFFER "POLYSEAMSEAL ALL-PURPOSE CAULKING" IN WHITE, BEIGE, LIGHT GRAY AND BROWN). FOR COSMETIC REASONS **DO NOT USE CLEAR OR SILICONE CAULKING**.

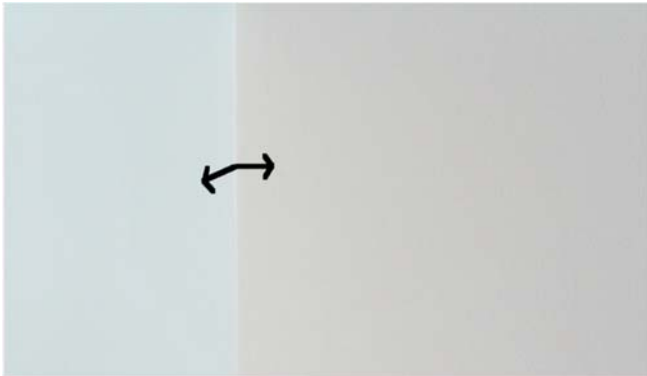

STEP 1 – MARK THE SPOT WHERE YOU WOULD LIKE THE CORNER SHELF TO GO. **IF YOU ARE INSTALLING A RECTANGLE SHELF, BE SURE TO LABEL ONE WALL FOR THE LONG SIDE OF THE SHELF AND THE OTHER WALL FOR THE SHORT SIDE OF THE SHELF.**

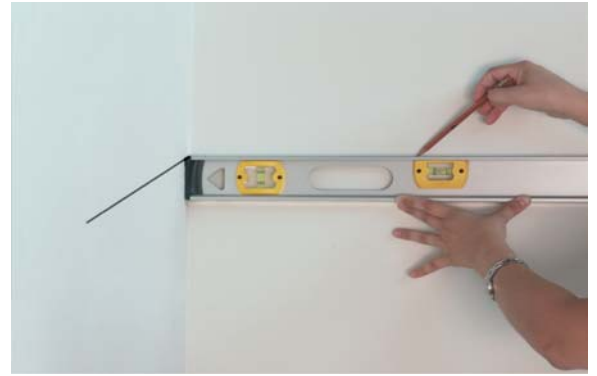

STEP 2 – USE A LEVEL AND DRAW TWO LEVELED LINES AT ABOUT THE SAME LENGTH OF THE SHELF, ONE AT EACH SIDE OF THE WALL WHERE THE SHELF IS GOING TO BE INSTALLED.

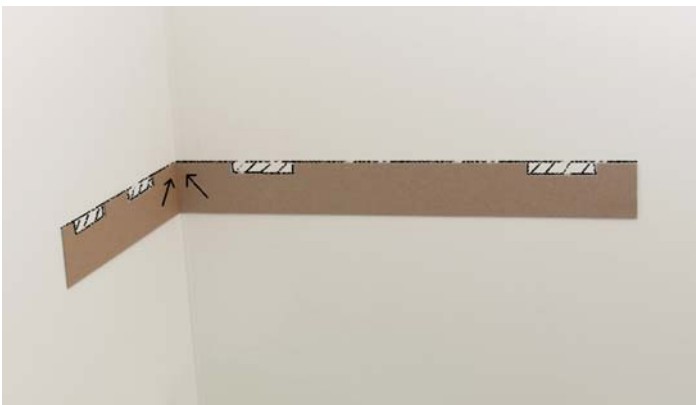

STEP 3 – USING THE SUPPLIED TEMPLATE MARK THE POSITION OF THE GROOVES ON THE WALL. THE ARROW ON THE TEMPLATE MUST POINT TO THE CORNER.



STEP 4 – USE DRILL TO START CUTTING THE GROOVES, FOLLOWED BY USING THE WALL-SAW. ONLY CUT THE AREA THAT IS MARKED. THEN, TEST TO FIT THE SHELF INTO THE GROOVES. **CLEAN ALL GROOVES AND WALLS FREE OF DUST.**



STEP 5 – APPLY 3/8" BEAD OF CAULKING ADHESIVE JUST BELOW THE LINES, AND IN THE GROOVES. INSTALL THE SHELF IMMEDIATELY BEFORE THE CAULKING DRIES. AFTER INSTALLATION, FILL ALL GAPS WITH MORE CAULKING IF NEEDED.



STEP 6 – PUSH THE SHELF IN PLACE. THEN USING A SPONGE CLEAN ALL EXCESS CAULKING. LET IT DRY OVER NIGHT. IF NECESSARY, YOU MAY PATCH AND PAINT ANY GAPS FOR A BETTER APPEARANCE.

HINTS AND SUGGESTIONS:

ALWAYS TEST FIT THE SHELF AND CLEAN ALL DUST BEFORE INTALLATION.

CEMENT, STUCCO OR SOFT STONE

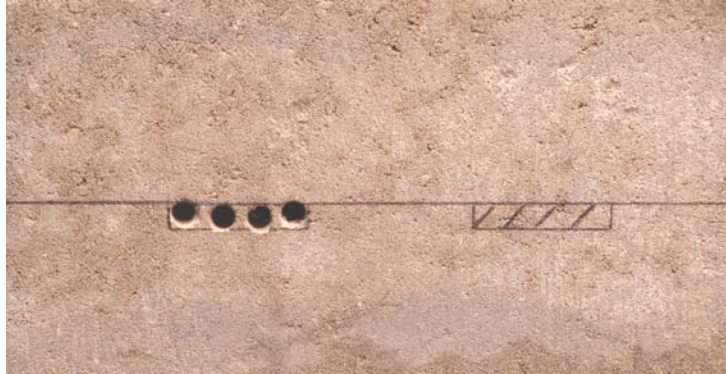

USE SMALL HAMMER DRILL AND A 7/16" CONCRETE BIT. DRILL FOUR HOLES IN THE MARKED AREA ABOUT 1" DEEP. IT IS OK TO CUT OUT BIGGER THAN MARKED AREA, AS CEMENT IS VERY EASY TO FILL.

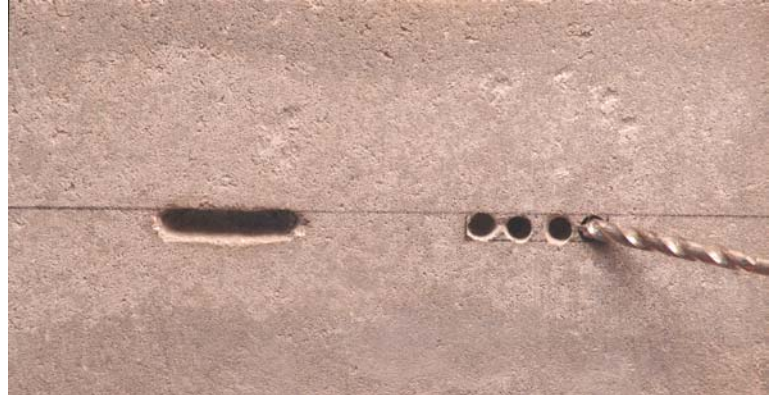

USE THE SAME DRILL AND DRILL BIT. START TO DRILL IN AN ANGLE TO DRILL OUT THE MATERIAL BETWEEN THE HOLES.

WOOD



GROOVES ON THE WOOD CAN VERY EASILY BE CUT OUT WITH PLATE JOINTER, IF YOU HAVE ONE, OTHERWISE USE A DRILL WITH 3/8" WOOD BIT. DRILL A FEW HOLES IN THE MARKED AREA 3/4" DEEP.

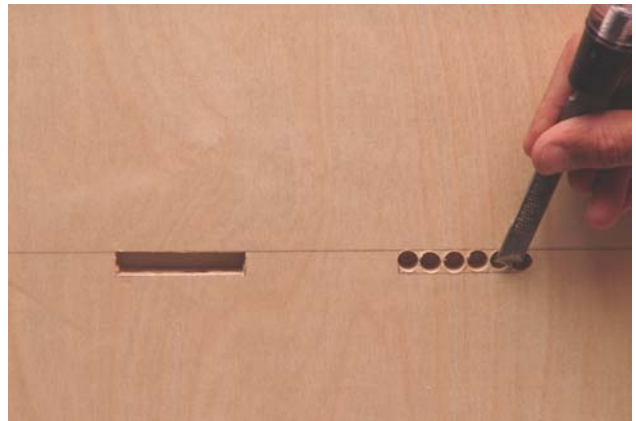

USE A WOOD CHESEL TO CUT AWAY THE MATERIAL BETWEEN THE HOLES.

TILE AND MARBLE WALLS

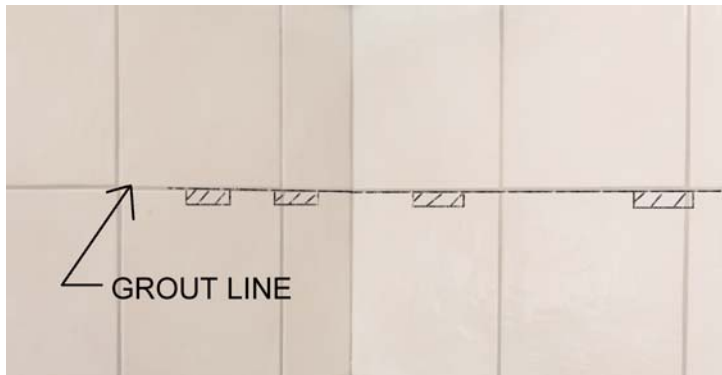

TO CUT LESS MATERIAL, WE SUGGEST POSTIONING YOUR SHELF AT THE GROUT LINE. IN THIS WAY YOU DON'T HAVE TO CUT ONE SIDE OF GROOVE. THEN USING A 1/8" TILE AND MARBLE DRILL BIT, DRILL A STARTER HOLE IN THE MARKED AREA.

****NOTE** WE STRONGLY SUGGEST USING A ROTO ZIP FOR CUTTING IN TILES AND MARBLE. IT IS THE SURE AND EASIEST WAY.**

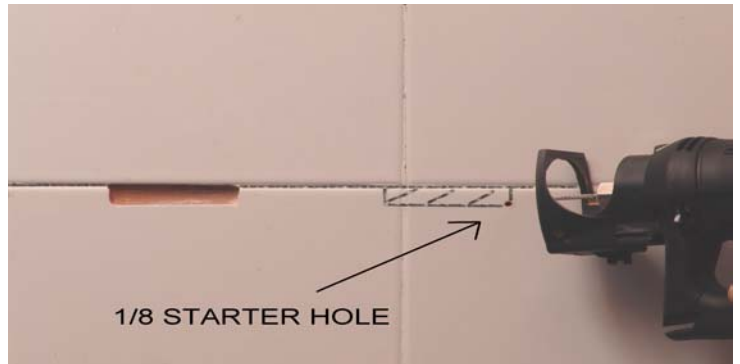

THEN USING YOUR ROTO ZIP TOOL WITH A TILE CUTTING BIT START TO CUT THE TILE ON THE LINE. CUTTING DEPTH SHOULD BE THE SAME AS TILE THINKNESS. AFTER THE TILE HAS BEEN CUT OUT YOU CAN CHISEL THE BACK BOARD OR WHATEVER MAY BE BEHIND THE TILE OR MARBLE.