

10 57 00/GLA
BuyLine 8617

GLADIATOR® GARAGEWORKS ORGANIZATION REIGNS SUPREME.



Gladiator® GarageWorks. Modular, rugged storage solutions. With major sleek factor.



Delight your customers with the ultimate storage solution for the garage.

Gladiator® GarageWorks products are designed specifically for the harsh garage environment. Durable steel construction resists warping and cracking, while the seamless design and thoughtful product features make organization easy. All of this innovation is wrapped in a stylish Tread Plate design making the garage work and look better.

Visit GladiatorGW.com to see a complete list of products and how they can transform your customer's garages.

You can also download and apply 3D models of Gladiator® GarageWorks products directly into your CAD designs by going to Google SketchUp.



GearWall® Panels

- Heavy Duty Slot-Wall System designed for Full Wall Coverage
- Comply with International Residential Building Codes
- Class A rated for Residential Interior Use
- Underwriters Laboratories Classified

GAWP082PMY – 2-pack,
12" x 96" total



GearTrack™ Channels

- Heavy-Duty Slot-Wall System designed for Partial Wall Coverage
- Comply with International Residential Building Codes
- Class A rated for Residential Interior Use
- Underwriters Laboratories Classified

GAWC042PPY – 2-pack,
6" x 8' total

GAWC0412PY – 12-pack,
6" x 48' total



Accessories hang on both GearTrack™ Channels and GearWall® Panels.



Modular Workbench Docking System

- Heavy-Duty
- Docking Space for Two Modules
- Patented Design

GAWB08MTRG – 8' Workbench

GAWB06MTRG – 6' Workbench (shown)



Folding Work Surface

- Each Tile is 1' x 1'
- Space-saving fold-away workstation
- Stainless steel work surface provides durable, solid workspace

Perfect for small repairs or gardening tasks

GAFS42KDSG



VersaTop Work Surface

- Sturdy 1.5" thick, sealed MDF work surface
- Connects 2 Welded Steel Modular Components to create a mobile workstation
- Easily docks under Modular Workbench

GAVT24SPSX

Also available: Powerstrip/Backsplash

GAAC68PSPG



Chillerator® Garage Refrigerator

- Cooling System Keeps Items Chilled or Frozen in High Heat Environments
- Built-In Heater Keeps Refrigerated Items Chilled in Very Cold Environments
- Step-Lock Front Casters; Swivel Rear Casters
- 5 Cu. Ft. Freezer Space
- Door Storage in Freezer Compartment
- ENERGY STAR® qualified
- 14 Cu. Ft. Refrigerator Space With Four Adjustable Spill Blocker™ Shelves

GARF19XXPK



Gladiator® Tile Floor Covering

- Each Tile is 1' x 1'
- Trim is Black Charcoal Tile
- Underwriters Laboratories Classified
- Drain Tiles and Trim also available
- Available in Silver or Charcoal



Gladiator® Roll Floor Covering

- Thickest Full-Coverage Residential Garage Roll Flooring on the Market
- Slip-Resistant Tread Plate Pattern
- 8' x 24' Includes 2" Flap for Seaming
- Underwriters Laboratories Classified



The Freezerator® Convertible Refrigerator/Freezer

- Top portion refrigerator or convertible to all freezer, bottom freezer
- Cooling System Keeps Items Chilled or Frozen in High Heat Environments
- Built-In Heater Keeps Refrigerated Items Chilled in Very Cold Environments
- Designed for Dual-Function Garage Duty
- Heavy-Duty Locking Casters

GAFZ21XXRK



Trash Compactor

- Perfect for the Garage, Saves Space in the Kitchen
- Step-Lock Front Caster and Swivel Rear Casters Provide Easy Maneuverability
- Compaction Ratio of 4:1

GACP15XXMG



Modular GearBox

- Extra-Deep Storage
- Stores Bulky Gear

GAGB272DRG

GAAC27MTRX

(Optional maple top)



Tall GearBox and Tall GearBox Lockers

- Adjustable Shelves
- Split Shelves
- Locking Tread Plate Doors

GATB302DRG
(Tall GearBox)

GATL302DRG
(Tall GearBox Locker)

GABK301PRS
(Optional Bracket Kit)



Wall GearBox

- Adjustable Shelves for Power Tools
- Rugged Construction

GAWG302DPG – 30"

Also Available
GAWG241DRG – 24"



Modular GearDrawer

- More Than a Tool Chest
- Five fully-extendable 22" Deep Drawers

GAGD275DGR

GAAC27MTRX

(Optional maple top)



Together we can make a sustainable difference.

At Whirlpool Corporation, we're committed to being the building and design



professionals' go-to source for eco-efficient appliances needed to design, construct, operate and maintain green homes. We want to partner with you in developing designs that can make a sustainable difference.

Serving the design professional.

Whirlpool offers a number of complimentary services that benefit the design community. Our new

offering of 3D digital models for Google SketchUp allows you to download Gladiator® product models from the Google 3D Warehouse right into your CAD designs. You can also connect with Google Earth to see your 3D design on a jobsite to share with clients.

You can also access **online continuing education, CSI three-part specifications and**

CAD details at

Sweets.com.

Professional courtesy

appliance discounts for AIA,

AIBD, NKBA and IIDA members' personal use

are also available.

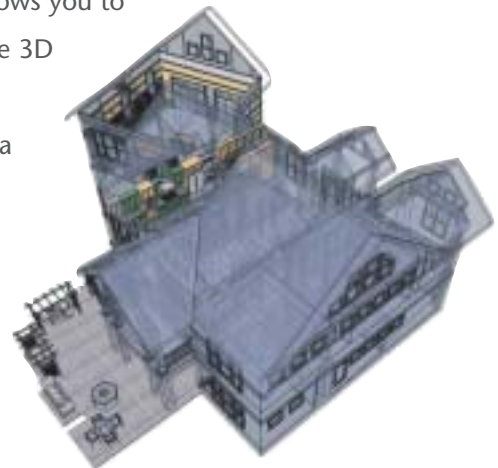

To find out more, visit insideadvantage.com/designers or call 800-253-3977.

