



511 SOUTH 7TH STREET
DELANO MN 55328
Phone: 763.972.2981
Fax: 763.972.2911

www.industriallouvers.com
ilinfo@industriallouvers.com

MODEL 486

STANDARD CONSTRUCTION

Blades to be .081" extruded aluminum 6063 mounted on 2" x 2" x 1/4" aluminum support angles.

Finish to be mill.

INSTALLATION

Model 486 should be installed in accordance with manufacturers recommended attachment method and in accordance with state and federal building codes.

WARRANTY

All materials and workmanship are warranted for a period of 1 year from date of completion.

MAINTENANCE

None required.

FEATURES

- All sizes are custom fabricated to meet project requirements.
- Vertical Blades
- Clip angles for installation.

OPTIONAL ACCESSORIES

Many optional accessories to the basic design are available at an additional cost. They include:

- Hinged access panels.
- Cap flashing at head.
- Invisible mullions for multiple section requirements.
- Mitered or Box corners
- Anodized or Kynar finish

Please contact the factory for other special requirements.

SUGGESTED SPECIFICATIONS

Furnish and install where indicated on the drawings ILI equipment screen Model 486 sightproof screen as manufactured by Industrial Louvers, Inc., Delano, MN. Vertical blades shall be of .081" extruded aluminum and supported by 2" x 2" x 1/4" aluminum angles at a maximum spacing of 60" o.c.

CATALOG NO. 486

Rev: AUG. 2010

MODEL 486

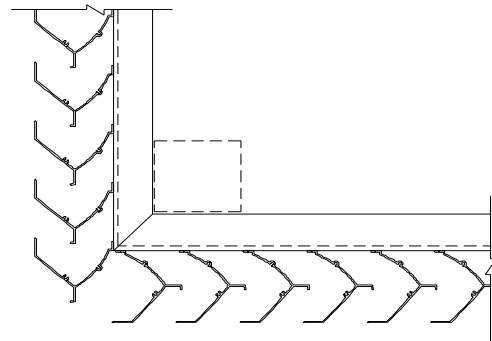
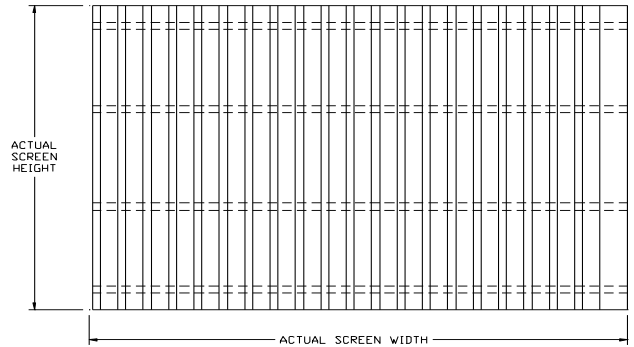
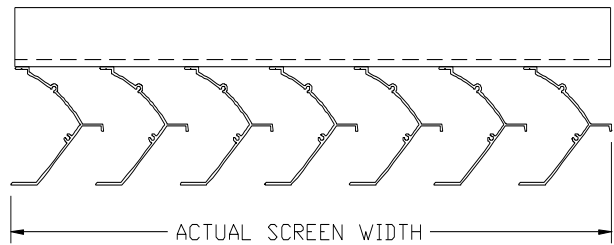
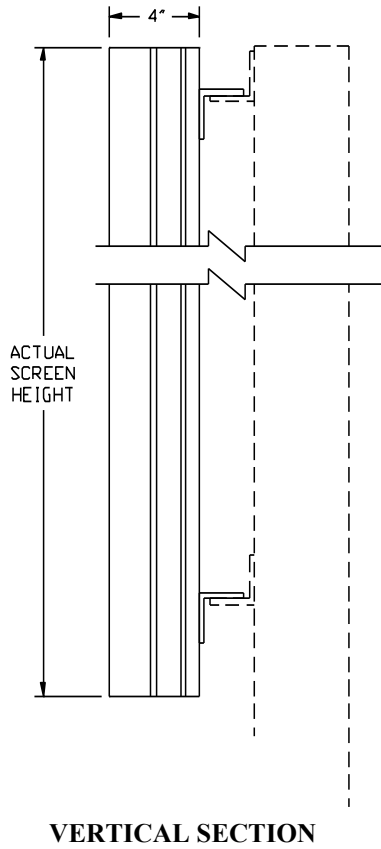

ACCESSORIES:

- FINISH _____
- COLOR _____
- OTHER _____

ITEM NO.	QTY	SIZE	Actual	<input type="checkbox"/>	M.O.	MULLION TYPE	NO. OF SECTIONS	REMARKS
		WIDTH		HEIGHT	<input type="checkbox"/>			

PROJECT _____

LOCATION _____

ARCH/ENGR. _____

CONTRACTOR _____

DATE _____

REPRESENTATIVE _____

ILI JOB NO. _____ REP NO. _____

Industrial Louvers, Inc. Phone: 763-972-2981
 511 South 7th Street Fax: 763-972-2911
 Delano, MN 55328

CATALOG NO. 486

Rev: AUG. 2010