



511 SOUTH 7TH STREET
DELANO MN 55328
Phone: 763.972.2981
Fax: 763.972.2911

www.industriallouvers.com
ilinfo@industriallouvers.com

MODEL 408

STANDARD CONSTRUCTION

Frame and blades to be 4" deep. Blades shall be 20-ga. galvanized steel and mounted in 16-ga. galvanized steel frames.

1/2" mesh 19 gauge galvanized wire bird screens in a removable formed steel frame.

Finish to be mill.

INSTALLATION

Model 408 should be installed in accordance with manufacturers recommended attachment method and in accordance with state and federal building codes.

WARRANTY

All materials and workmanship are warranted for a period of 1 year from date of completion.

MAINTENANCE

None required.

FEATURES

- All sizes are custom fabricated to meet project requirements.
- Integral water spouts at the jambs to drain water from the blades to the exterior of the building.
- Clip angles for installation.
- All welded assembly.

OPTIONAL ACCESSORIES

Many optional accessories to the basic design are available at an additional cost. They include:

- Extended sill flashing
- Flanged frames of various sizes
- Hinged access panels
- Subframes
- Continuous perimeter angles
- Visible or invisible mullions for multiple section requirements.
- Baked Enamel or Kynar finish

NOTE: Manufacturer of Kynar finish does not warrant Kynar paint on steel.

Please contact the factory for other special requirements.

SUGGESTED SPECIFICATIONS

Furnish and install as indicated on the drawings ILI Model 408 drainable blade louvers as manufactured by Industrial Louvers, Inc., Delano, MN. Blades shall be 20-ga. galvanized steel and mounted in 16-ga. galvanized steel frames. Sill and jamb frames shall be continuously welded and caulked to help prevent water penetration to interior wall construction. Blades are attached by means of all-welded construction.

The louvers shall have a minimum of 8.37 sq. ft. (52%) free area on a 48 inch x 48 inch louver. The rating shall show a maximum water penetration of .01 oz. at an air flow of 942.9 FPM. The Static Pressure Loss to be not more than .15 inch of water gage at an air flow of 932 FPM free area velocity.

CATALOG NO. 408

Rev: JANUARY 2004

MODEL 408

Free Area in Square Feet And Square Meters

Free Area AMCA Licensed for openings up to 72" X 120".
For free area data for larger openings, contact factory.

FREE AREA IN SQUARE FEET AND SQUARE METERS

3048. mm	0.461	0.984	1.507	2.030	2.553	3.076
120"	4.960	10.590	16.220	21.850	27.480	33.11
2743.2 mm	0.414	0.883	1.352	1.821	2.290	2.760
108"	4.450	9.501	14.552	19.603	24.654	29.706
2438.4 mm	0.366	0.782	1.197	1.612	2.028	2.443
96"	3.940	8.412	12.884	17.357	21.829	26.301
2133.6 mm	0.319	0.680	1.042	1.404	1.765	2.127
84"	3.430	7.323	11.217	15.110	19.003	22.897
1828.8 mm	0.271	0.579	0.887	1.195	1.503	1.811
72"	2.920	6.234	9.549	12.863	16.178	19.492
1524. mm	0.224	0.478	0.732	0.986	1.240	1.494
60"	2.410	5.146	7.881	10.617	13.352	16.088
1219.2 mm	0.176	0.377	0.577	0.777	0.978	1.178
48"	1.900	4.057	6.213	8.370	10.527	12.683
914.4 mm	0.129	0.275	0.422	0.569	0.715	0.862
36"	1.390	2.968	4.546	6.123	7.701	9.279
609.6 mm	0.081	0.174	0.267	0.360	0.453	0.545
24"	0.880	1.879	2.878	3.877	4.876	5.874
304.8 mm	0.034	0.073	0.112	0.151	0.190	0.229
12"	0.370	0.790	1.210	1.630	2.050	2.47
H/W	304.8 mm	609.6 mm	914.4 mm	1219.2 mm	1524. mm	1828.8 mm
	12"	24"	36"	48"	60"	72"

Performance Chart

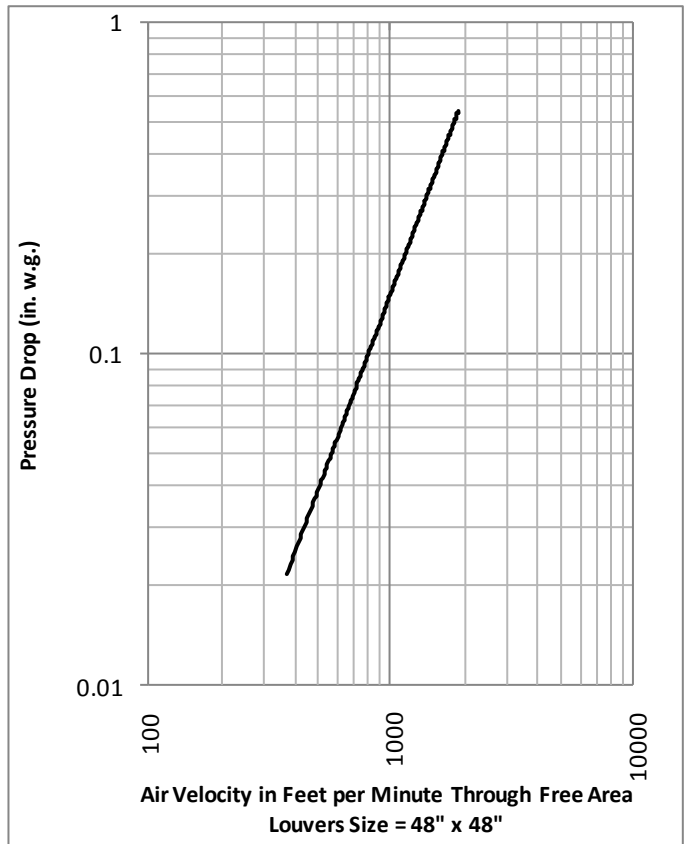

Water Penetration Chart

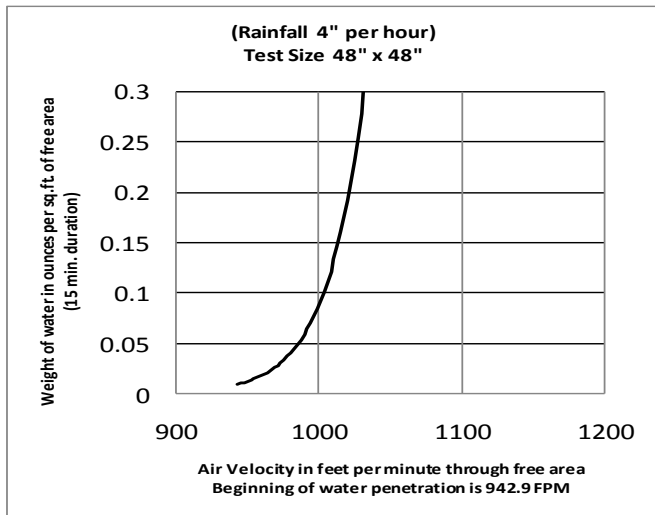

Ratings do not include the effect of a bird screen.

NOTE: All tests are for standard .075 lb./cu. ft.

CATALOG NO. 408

Rev: JANUARY 2004



MODEL 408

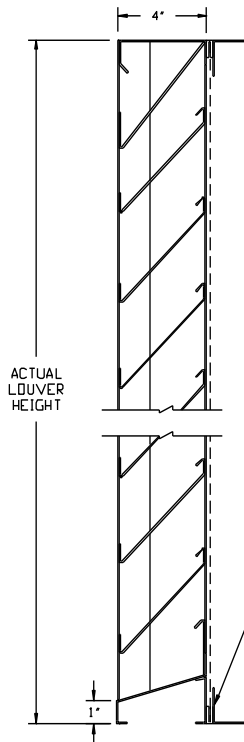

VERTICAL SECTION

1 1/2" x 1 1/2"
x 16 GA. GALV. CLIP
ANGLES @ 18° D/C.
(MILL FINISH),
ATTACHED TO
LOUVERS W/1" X
#12 S/M SCREWS
@ JOBSITE. (ALL
ANCHORS INTO
SURROUNDING
CONDITIONS BY
OTHERS.)

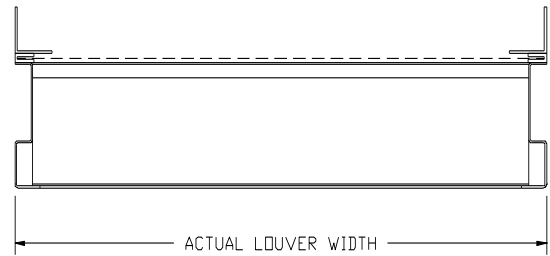

HORIZONTAL SECTION

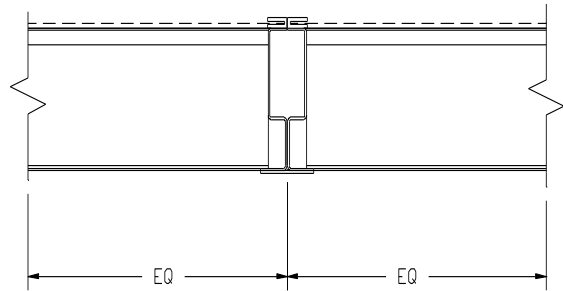

VISIBLE MULLION DETAIL

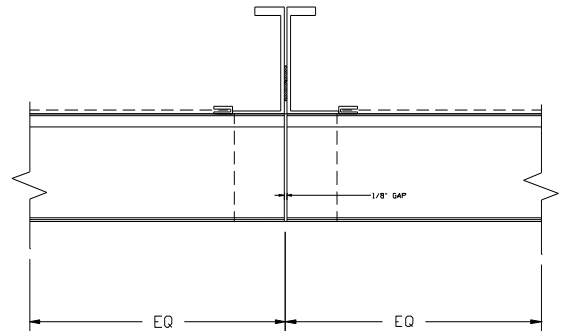

INVISIBLE MULLION DETAIL

ACCESSORIES:

- SILL FLASHING - DEPTH _____
- SCREEN _____
- FINISH _____
- COLOR _____
- OTHER _____

ITEM NO.	QTY	SIZE		M.O.	MULLION TYPE	NO. OF SECTIONS	REMARKS
		Actual	HEIGHT				
		WIDTH					

PROJECT _____ **REPRESENTATIVE** _____
LOCATION _____ **ILI JOB NO.** _____ **REP NO.** _____
ARCH/ENGR. _____ Industrial Louvers, Inc. Phone: 763-972-2981
511 South 7th Street Fax: 763-972-2911
CONTRACTOR _____ Delano, MN 55328
DATE _____ CATALOG NO. 408 Rev: JANUARY 2004