



511 SOUTH 7TH STREET
DELANO MN 55328
Phone: 763.972.2981
Fax: 763.972.2911

www.industriallouvers.com
ilinfo@industriallouvers.com

MODEL 614SXP

STANDARD CONSTRUCTION

Frame and blades to be 6" deep 16 ga. Galvanized Steel.

1/2" mesh 19 gauge galvanized wire bird screens in a removable formed steel frame.

Finish to be mill.

INSTALLATION

Model 614SXP should be installed in accordance with manufacturers recommended attachment method and in accordance with state and federal building codes.

WARRANTY

All materials and workmanship are warranted for a period of 1 year from date of completion.

MAINTENANCE

None required.

FEATURES

- All sizes are custom fabricated to meet project requirements.
- Integral water spouts at the jambs to drain water from the blades to the exterior of the building.
- Clip angles for installation.
- All welded assembly.

OPTIONAL ACCESSORIES

Many optional accessories to the basic design are available at an additional cost. They include:

- Extended sill flashing
- Flanged frames of various sizes
- Hinged access panels
- Subframes
- Continuous perimeter angles
- Visible or invisible mullions for multiple section requirements.
- Baked Enamel or Kynar finish

Note: Manufacturers of Kynar finishes do not warrant Kynar paint on steel.

Please contact the factory for other special requirements.

SUGGESTED SPECIFICATIONS

Furnish and install where indicated on the drawings ILI extra performance weather-resistant drainable frame Model 614SXP louvers as manufactured by Industrial Louvers, Inc., Delano, MN. Frames and blade thickness to be 18 gauge galvanized steel. The frame shall be designed to collect and drain water to exterior at sill by means of channels in the jambs. Sill and jamb frames shall be continuously welded and caulked to help prevent water penetration to interior wall construction. Blades are attached by means of all-welded construction.

The louvers shall have a minimum of 7.05 sq. ft. (44%) free area on a 48 inch x 48 inch louvers.

CATALOG NO. 614SXP

Rev: JULY 2010

MODEL 614SXP

Free Area in Square Feet And Square Meters

Free Area for openings up to 72" X 120".
For free area data for larger openings, contact factory.

FREE AREA IN SQUARE FEET AND SQUARE METERS

3048. mm	0.386	0.850	1.314	1.779	2.243	2.707
120"	4.160	9.156	14.152	19.148	24.144	29.14
2743.2 mm	0.345	0.761	1.176	1.591	2.007	2.422
108"	3.722	8.192	12.662	17.132	21.602	26.072
2438.4 mm	0.305	0.671	1.038	1.404	1.771	2.137
96"	3.284	7.228	11.172	15.116	19.060	23.004
2133.6 mm	0.264	0.582	0.899	1.217	1.534	1.852
84"	2.847	6.265	9.683	13.101	16.519	19.937
1828.8 mm	0.223	0.492	0.761	1.030	1.298	1.567
72"	2.409	5.301	8.193	11.085	13.977	16.869
1524. mm	0.183	0.403	0.622	0.842	1.062	1.282
60"	1.971	4.337	6.703	9.069	11.435	13.801
1219.2 mm	0.142	0.313	0.484	0.655	0.826	0.997
48"	1.533	3.373	5.213	7.053	8.893	10.733
914.4 mm	0.101	0.223	0.346	0.468	0.590	0.712
36"	1.096	2.410	3.724	5.038	6.352	7.666
609.6 mm	0.061	0.134	0.207	0.280	0.354	0.427
24"	0.658	1.446	2.234	3.022	3.810	4.598
304.8 mm	0.020	0.044	0.069	0.093	0.118	0.142
12"	0.220	0.482	0.744	1.006	1.268	1.530
H/W	304.8 mm	609.6 mm	914.4 mm	1219.2 mm	1524. mm	1828.8 mm
	12"	24"	36"	48"	60"	72"



CATALOG NO. 614SXP

Rev: JULY 2010

MODEL 614SXP

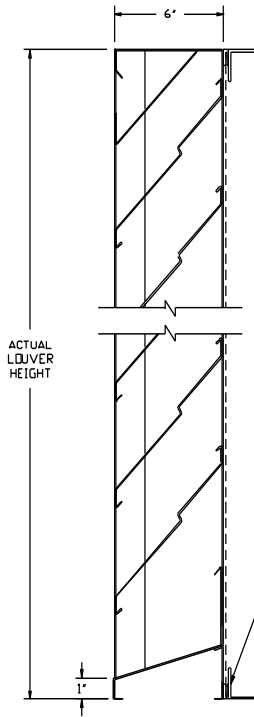

VERTICAL SECTION

1 1/2" x 1 1/2"
x 16 GA. GALV. CLIP
ANGLES @ 18° D/C.
(MILL. FINISH).
ATTACHED TO
LOUVERS W/1" X
#12 S/M SCREWS
@ JOBSITE. (ALL
ANCHORS INTO
SURROUNDING
CONDITIONS BY
OTHERS.)

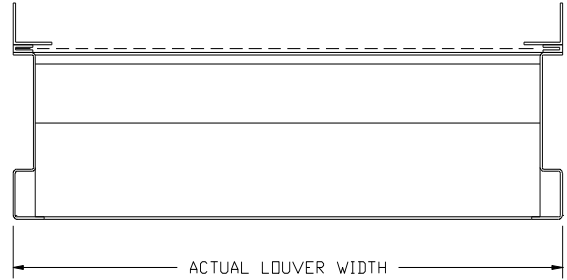

HORIZONTAL SECTION

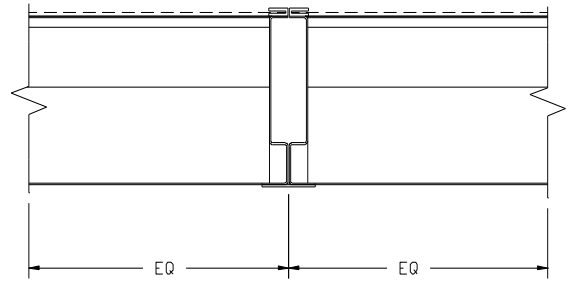

VISIBLE MULLION DETAIL

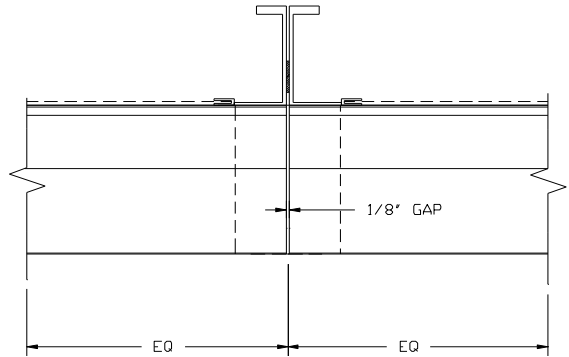

INVISIBLE MULLION DETAIL

ACCESSORIES:

- SILL FLASHING - DEPTH _____
- SCREEN _____
- FINISH _____
- COLOR _____
- OTHER _____

ITEM NO.	QTY	SIZE Actual <input type="checkbox"/> M.O. <input type="checkbox"/>		MULLION TYPE	NO. OF SECTIONS	REMARKS
		WIDTH	HEIGHT			

PROJECT _____	REPRESENTATIVE _____
LOCATION _____	ILI JOB NO. _____ REP NO. _____
ARCH/ENGR. _____	Industrial Louvers, Inc. Phone: 763-972-2981
CONTRACTOR _____	511 South 7th Street Fax: 763-972-2911
DATE _____	Delano, MN 55328
CATALOG NO. 614SXP Rev: JULY 2010	