



511 SOUTH 7TH STREET
DELANO MN 55328
Phone: 763.972.2981
Fax: 763.972.2911

www.industriallouvers.com
ilinfo@industriallouvers.com

MODEL 414SXP

STANDARD CONSTRUCTION

Frame and blades to be 4" deep 18 gauge galvanized steel.

1/2" mesh 19 gauge galvanized wire bird screens in a removable formed steel frame.

Finish to be mill.

TECHNICAL DATA



Industrial Louvers, Inc. certifies that Model 414SXP shown hereon is licensed to bear the AMCA Seal. The ratings shown are based on tests and procedures performed in accordance with AMCA Publication 511 and comply with the requirements of the AMCA Certified Ratings Program. The AMCA Certified Ratings Seal applies to air performance ratings and water penetration ratings.

INSTALLATION

Model 414SXP should be installed in accordance with manufacturers recommended attachment method and in accordance with state and federal building codes.

WARRANTY

All materials and workmanship are warranted for a period of 1 year from date of completion.

MAINTENANCE

None required.

FEATURES

- All sizes are custom fabricated to meet project requirements.
- Integral water spouts at the jambs to drain water from the blades to the exterior of the building.
- Clip angles for installation.
- All welded assembly.

OPTIONAL ACCESSORIES

Many optional accessories to the basic design are available at an additional cost. They include:

- Extended sill flashing
- Flanged frames of various sizes
- Hinged access panels
- Subframes
- Continuous perimeter angles
- Visible or invisible mullions for multiple section requirements.
- Baked Enamel or Kynar finish

NOTE: Manufacturer of kynar finish does not warrant paint on steel.

Please contact the factory for other special requirements.

SUGGESTED SPECIFICATIONS

Furnish and install where indicated on the drawings ILI extra performance weather-resistant drainable frame Model 414SXP louvers as manufactured by Industrial Louvers, Inc., Delano, MN. Frames and blade thickness to be 18 gauge galvanized steel. The frame shall be designed to collect and drain water to exterior at sill by means of channels in the jambs. Sill and jamb frames shall be continuously welded and caulked to prevent water penetration to interior wall construction. Blades are attached by means of all-welded construction.

Louvers shall bear the AMCA Certified Ratings Seal for both air performance and water penetration. The louvers shall have a minimum of 7.89 sq. ft. (49%) free area on a 48 inch x 48 inch louvers. The rating shall show a maximum water penetration of .01 oz. at an air flow of 823.8 FPM. The Static Pressure Loss to be not more than .15 inch of water gage at an air flow of 843 FPM free area velocity.

CATALOG NO. 414SXP

Rev: JANUARY 2004

MODEL 414SXP

Free Area in Square Feet And Square Meters

Free Area AMCA Licensed for openings up to 72" X 120".
For free area data for larger openings, contact factory.

FREE AREA IN SQUARE FEET AND SQUARE METERS

3048. mm	0.437	0.936	1.435	1.934	2.433	2.932
120"	4.700	10.072	15.444	20.816	26.188	31.56
2743.2 mm	0.392	0.839	1.287	1.734	2.181	2.629
108"	4.213	9.030	13.846	18.662	23.478	28.294
2438.4 mm	0.347	0.742	1.138	1.534	1.930	2.325
96"	3.727	7.987	12.248	16.508	20.768	25.029
2133.6 mm	0.301	0.645	0.990	1.334	1.678	2.022
84"	3.240	6.945	10.649	14.354	18.059	21.763
1828.8 mm	0.256	0.549	0.841	1.134	1.426	1.719
72"	2.753	5.902	9.051	12.200	15.349	18.498
1524. mm	0.211	0.452	0.693	0.934	1.174	1.415
60"	2.267	4.860	7.453	10.046	12.639	15.232
1219.2 mm	0.166	0.355	0.544	0.733	0.923	1.112
48"	1.780	3.817	5.855	7.892	9.929	11.967
914.4 mm	0.120	0.258	0.396	0.533	0.671	0.809
36"	1.293	2.775	4.256	5.738	7.220	8.701
609.6 mm	0.075	0.161	0.247	0.333	0.419	0.505
24"	0.807	1.732	2.658	3.584	4.510	5.436
304.8 mm	0.030	0.064	0.099	0.133	0.168	0.202
12"	0.320	0.690	1.060	1.430	1.800	2.17
H/W	304.8 mm	609.6 mm	914.4 mm	1219.2 mm	1524. mm	1828.8 mm
	12"	24"	36"	48"	60"	72"

Performance Chart

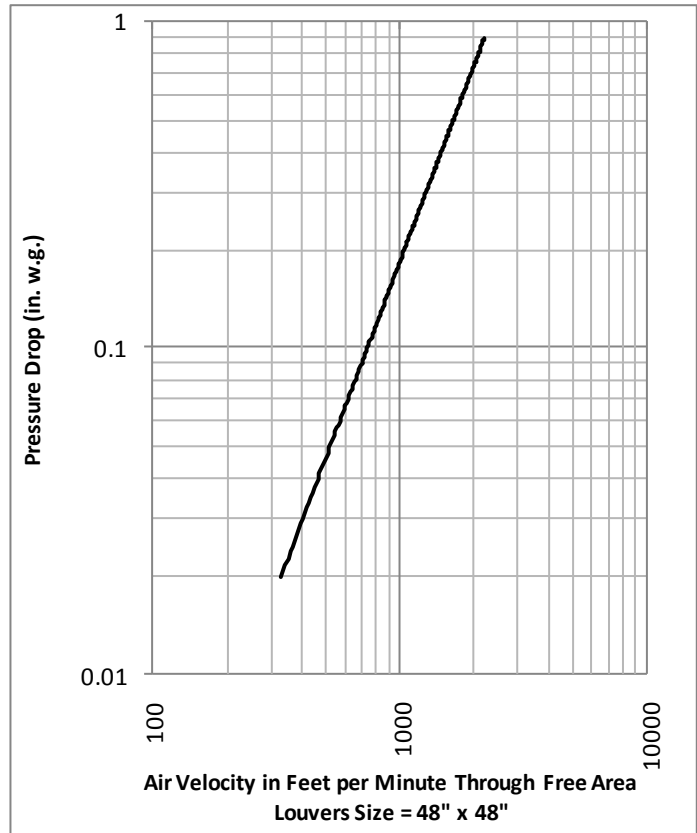

The AMCA Certified Ratings Seal applies to Air Capacities in the intake mode only.

Water Penetration Chart

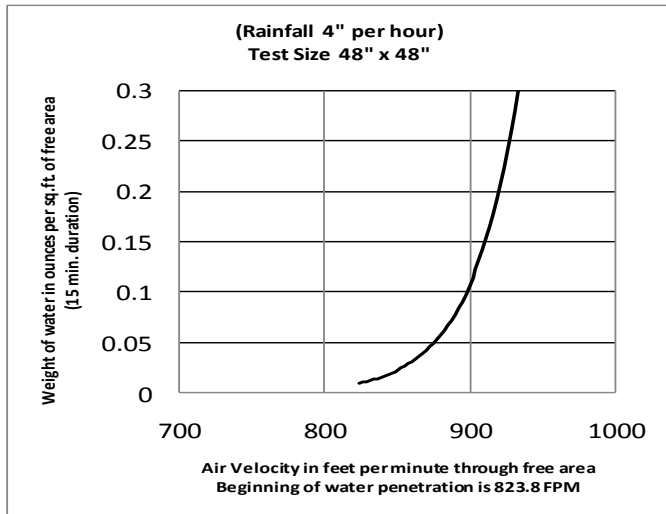

Ratings do not include the effect of a bird screen.

NOTE: All tests are for standard .075 lb./cu. ft.

CATALOG NO. 414SXP

Rev: JANUARY 2004



Industrial Louvers, Inc. certifies that Model 414SXP shown hereon is licensed to bear the AMCA Seal. The ratings shown are based on tests and procedures performed in accordance with AMCA Publication 511 and comply with the requirements of the AMCA Certified Ratings Program. The AMCA Certified Ratings Seal applies to air performance ratings and water penetration ratings.



MODEL 414SXP

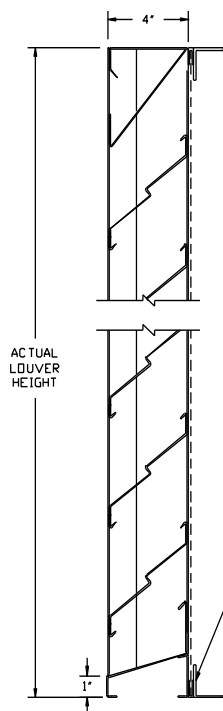

VERTICAL SECTION

1 1/2" x 1 1/2"
x 16 GA. GALV. CLIP
ANGLES @ 18° D/C.
(MILL FINISH),
ATTACHED TO
LOUVERS W/1" X
#12 S/M SCREWS
@ JOBSITE. (CALL
ANCHORS INTO
SURROUNDING
CONDITIONS BY
OTHERS.)

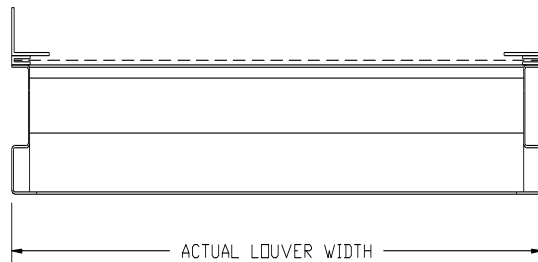

HORIZONTAL SECTION

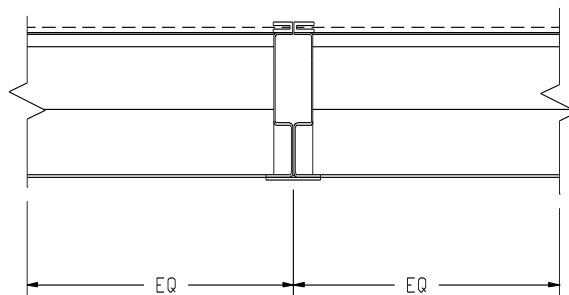

VISIBLE MULLION DETAIL

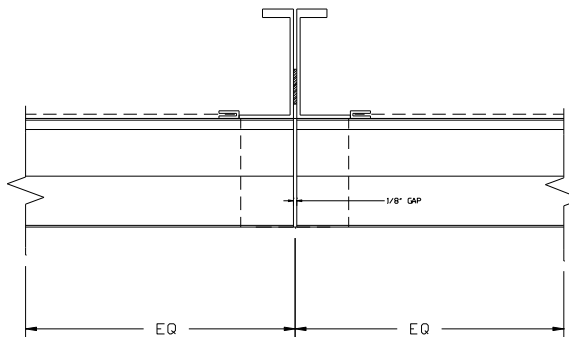

INVISIBLE MULLION DETAIL

ACCESSORIES:

- SILL FLASHING - DEPTH _____
- SCREEN _____
- FINISH _____
COLOR _____
- OTHER _____

ITEM NO.	QTY	SIZE	Actual	M.O.	MULLION TYPE	NO. OF SECTIONS	REMARKS
		WIDTH	HEIGHT				

PROJECT _____	REPRESENTATIVE _____
LOCATION _____	ILI JOB NO. _____ REP NO. _____
ARCH/ENGR. _____	Industrial Louvers, Inc. Phone: 763-972-2981
CONTRACTOR _____	511 South 7th Street Fax: 763-972-2911
DATE _____	Delano, MN 55328
CATALOG NO. 414SXP Rev: JANUARY 2004	