



511 SOUTH 7TH STREET
DELANO MN 55328
Phone: 763.972.2981
Fax: 763.972.2911

www.industriallouvers.com
ilinfo@industriallouvers.com

MODEL 413XP

STANDARD CONSTRUCTION

Frame and blades to be 4" deep 18 gauge galvanized steel.

1/2" mesh 19 gauge galvanized wire bird screens in a removable formed steel frame.

Finish to be mill.

INSTALLATION

Model 413XP should be installed in accordance with manufacturers recommended attachment method and in accordance with state and federal building codes.

WARRANTY

All materials and workmanship are warranted for a period of 1 year from date of completion.

MAINTENANCE

None required.

FEATURES

- All sizes are custom fabricated to meet project requirements.
- Integral water spouts at the jambs to drain water from the blades to the exterior of the building.
- Clip angles for installation.
- All welded assembly.

OPTIONAL ACCESSORIES

Many optional accessories to the basic design are available at an additional cost. They include:

- Extended sill flashing
- Flanged frames of various sizes
- Hinged access panels
- Subframes
- Continuous perimeter angles
- Visible or invisible mullions for multiple section requirements.
- Baked Enamel or Kynar finish

NOTE: Manufacturer of Kynar finish does not warrant Kynar paint on steel.

Please contact the factory for other special requirements.

SUGGESTED SPECIFICATIONS

Furnish and install where indicated on the drawings ILI extra performance weather-resistant drainable frame Model 413XP louvers as manufactured by Industrial Louvers, Inc., Delano, MN. Frames and blade thickness to be 18 gauge galvanized steel. The frame shall be designed to collect and drain water to exterior at sill by means of channels in the jambs. Sill and jamb frames shall be continuously welded and caulked to prevent water penetration to interior wall construction. Blades are attached by means of all-welded construction.

The louvers shall have a minimum of 8.45 sq. ft. (53%) free area on a 48 inch x 48 inch louvers. The testing shall show a maximum water penetration of .01 oz. at an air flow of 715 FPM. The Static Pressure Loss to be not more than .15 inch of water gage at an air flow of 789 FPM free area velocity.

CATALOG NO. 413XP

Rev: JULY 2010

MODEL 413SXP

Free Area in Square Feet And Square Meters

Free Area for openings up to 72" X 120".
For free area data for larger openings, contact factory.

FREE AREA IN SQUARE FEET AND SQUARE METERS

3048. mm	0.470	1.007	1.544	2.081	2.618	3.155
120"	5.060	10.840	16.620	22.400	28.180	33.96
2743.2 mm	0.421	0.902	1.384	1.865	2.346	2.828
108"	4.534	9.715	14.895	20.075	25.255	30.436
2438.4 mm	0.372	0.798	1.224	1.649	2.075	2.500
96"	4.009	8.589	13.170	17.750	22.331	26.911
2133.6 mm	0.324	0.693	1.063	1.433	1.803	2.173
84"	3.483	7.464	11.445	15.425	19.406	23.387
1828.8 mm	0.275	0.589	0.903	1.217	1.531	1.845
72"	2.958	6.339	9.720	13.100	16.481	19.862
1524. mm	0.226	0.484	0.743	1.001	1.259	1.518
60"	2.432	5.213	7.994	10.776	13.557	16.338
1219.2 mm	0.177	0.380	0.583	0.785	0.988	1.190
48"	1.907	4.088	6.269	8.451	10.632	12.813
914.4 mm	0.129	0.275	0.422	0.569	0.716	0.863
36"	1.381	2.963	4.544	6.126	7.707	9.289
609.6 mm	0.080	0.171	0.262	0.353	0.444	0.535
24"	0.856	1.837	2.819	3.801	4.783	5.764
304.8 mm	0.031	0.066	0.102	0.137	0.173	0.208
12"	0.330	0.712	1.094	1.476	1.858	2.240
H/W	304.8 mm	609.6 mm	914.4 mm	1219.2 mm	1524. mm	1828.8 mm
	12"	24"	36"	48"	60"	72"

Performance Chart

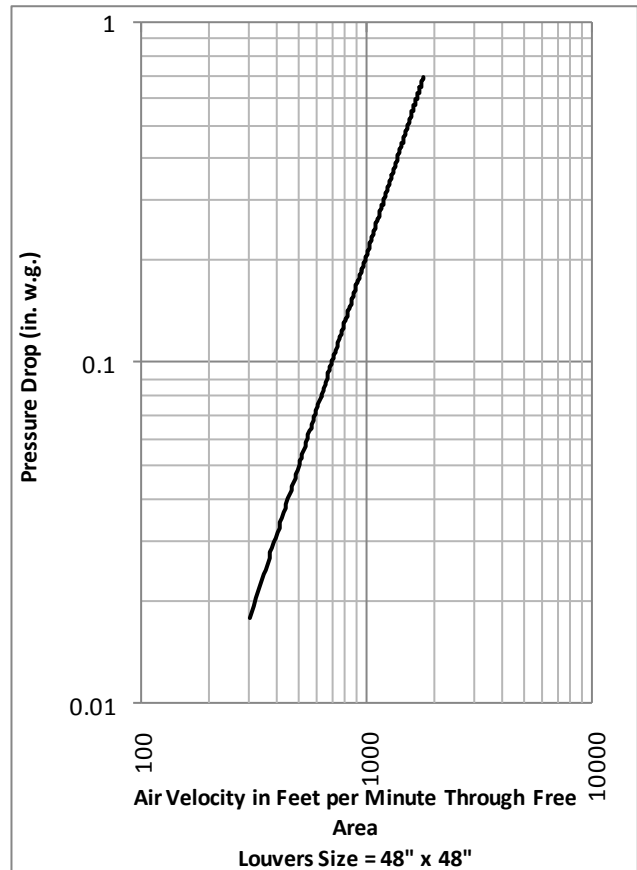

Water Penetration Chart

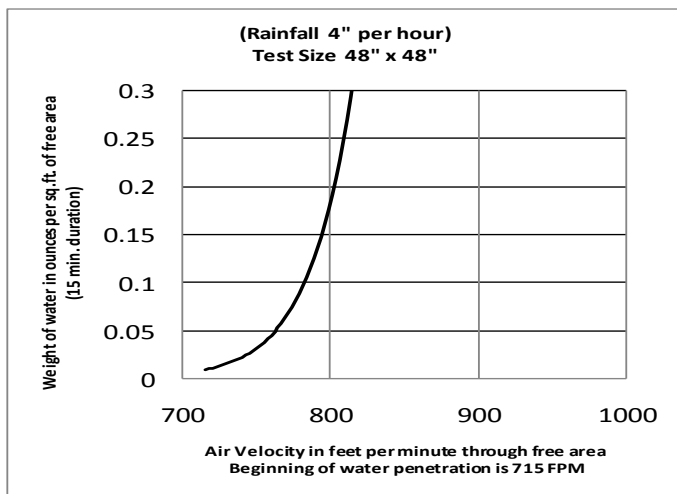

Testing does not include the effect of a bird screen.

NOTE: All tests are for standard .075 lb./cu. ft.

CATALOG NO. 413SXP

Rev: JULY 2010



MODEL 413SXP

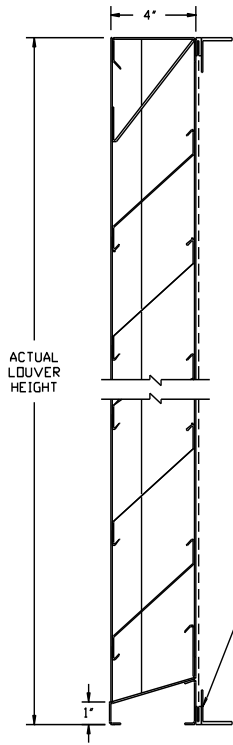

VERTICAL SECTION

1 1/2" x 1 1/2"
x 16 GA. GALV. CLIP
ANGLES @ 18° D/C.
(MILL FINISH),
ATTACHED TO
LOUVERS W/1" X
#12 S/M SCREWS
@ JOBSITE. (ALL
ANCHORS INTO
SURROUNDING
CONDITIONS BY
OTHERS.)

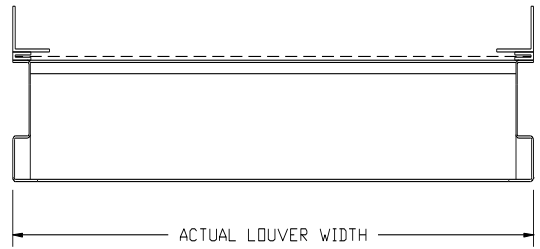

HORIZONTAL SECTION

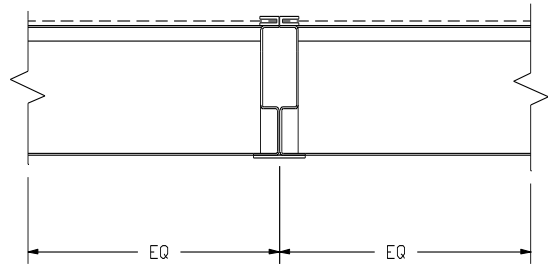

VISIBLE MULLION DETAIL

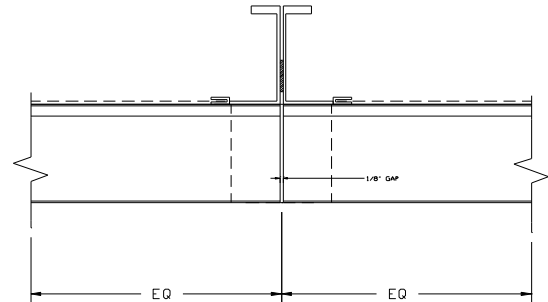

INVISIBLE MULLION DETAIL

ACCESSORIES:

- SILL FLASHING - DEPTH _____
- SCREEN _____
- FINISH _____
- COLOR _____
- OTHER _____

ITEM NO.	QTY	SIZE		M.O.	MULLION TYPE	NO. OF SECTIONS	REMARKS
		Actual	Width				
				<input type="checkbox"/>			
				<input type="checkbox"/>			
				<input type="checkbox"/>			

PROJECT _____	REPRESENTATIVE _____
LOCATION _____	ILI JOB NO. _____ REP NO. _____
ARCH/ENGR. _____	Industrial Louvers, Inc. Phone: 763-972-2981
CONTRACTOR _____	511 South 7th Street Fax: 763-972-2911
DATE _____	Delano, MN 55328
CATALOG NO. 413SXP Rev: JULY 2010	