

# tracmod

permanent powered platform

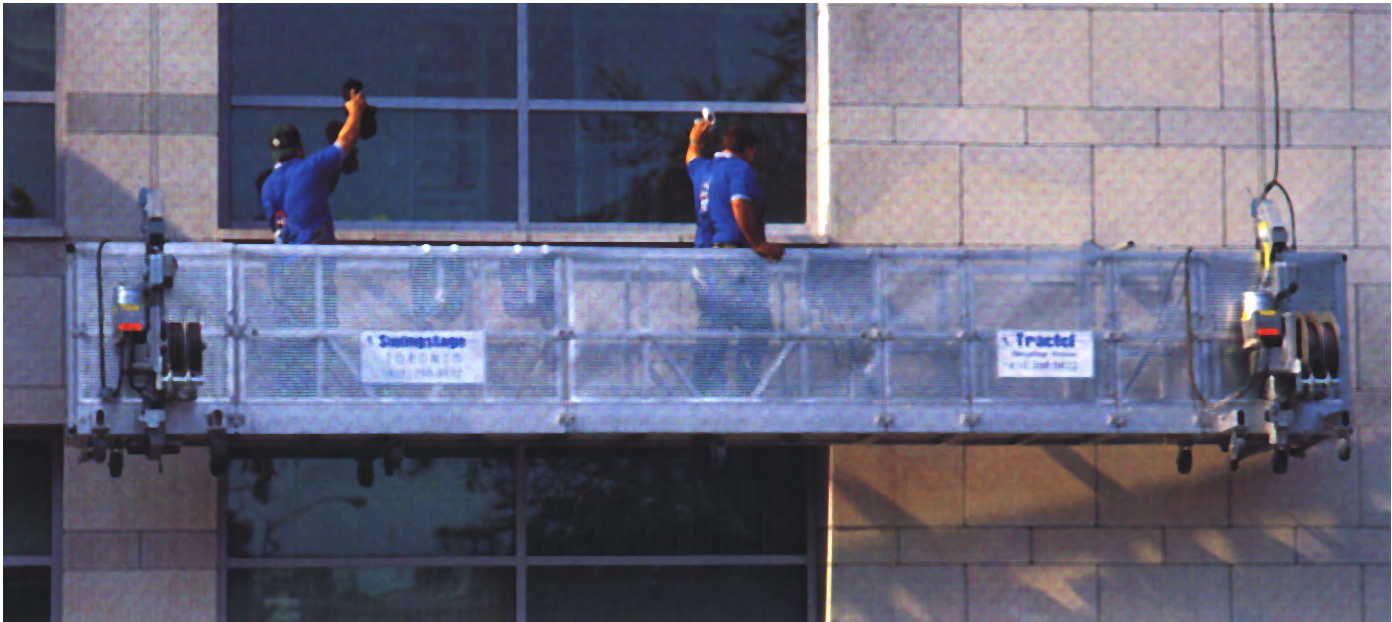

# tracmod *permanent powered platforms*



**Powered platforms** are the most popular solution for exterior building access in North America.

**SWINGSTAGE®** has been the leader in the design and provision of these systems for many years. Our extensive experience is reflected in the advanced features incorporated into our products.

The **TRACMOD** powered platform is fitted with the latest in **TIRAK®** hoisting systems, with all code-required safety features fully integrated. Extensive use of corrosion-resistant materials and robust construction ensures reliability and long life. Systems are available with 2-wire suspension or 4-wire suspension. The use of our patented modular platform concept allows the platform length to be adapted to suit various building modules.

**tracmod** assembly  
with fold-out end

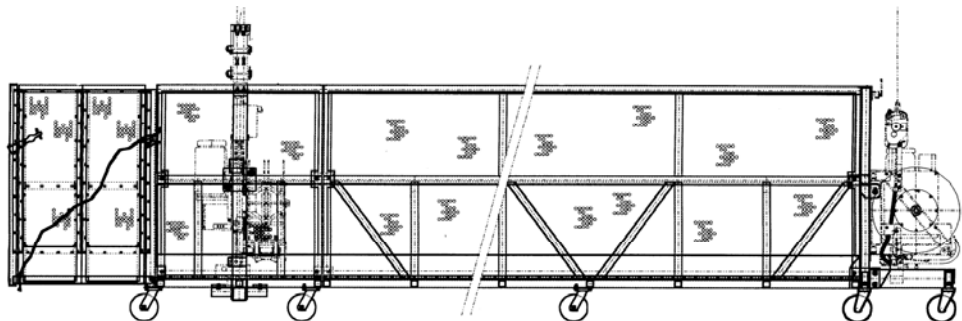

 **Tractel** Ltd.  
Swingstage Division

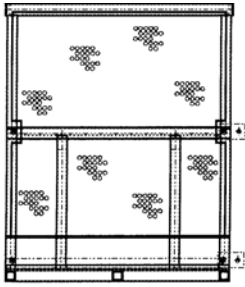

1m (3') section

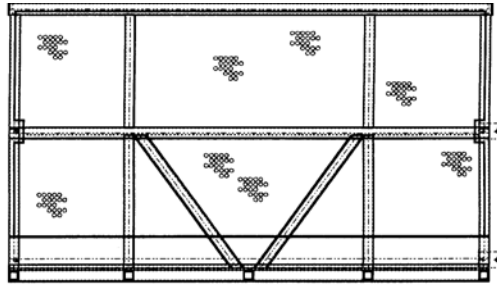

2m (6'-6") section

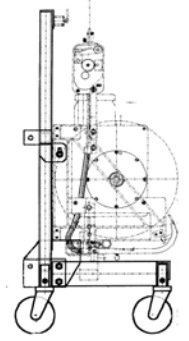

end stirrup

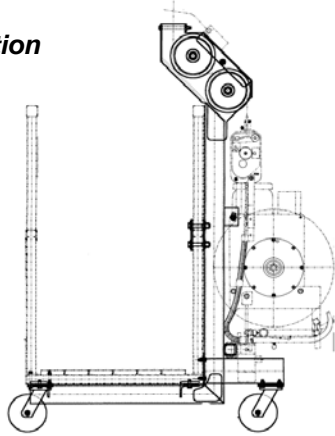

Intermediate stirrup

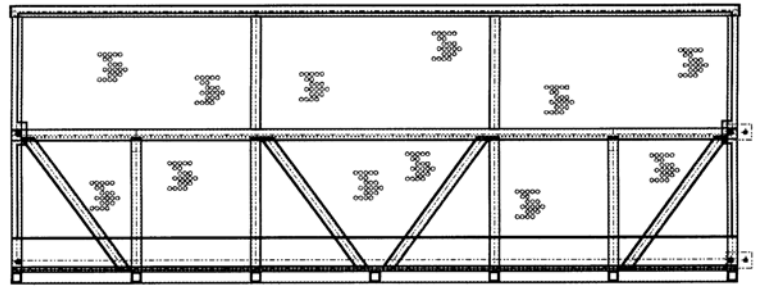

3m (10') section

P L A T F O R M	N O M I N A L	L E N G T H	Single Module				ASSEMBLY	Min. R/R = 0.5 O/A		Distance between ropes.....R/R Platform Overall Length.....O/A Platform Total Weight.....WT								
			Nom. Lg.	m	0.5	1.0		2.0	3.0	C- STIRRUP				END STIRRUP				
				ft	1'-9"	3'-0"		6'-5"	9'-8"	Lift Ht.	R/R	O/A	WT	R/R	O/A	WT	R/R	O/A
			Weight lb.	13.5	50.5	97	142											
			2.0m (6'-6")			X		2	1 x	1 x 150	2 x 110	2 x 200	1 x 150	2 x 110	2 x 200			
									1 x	1 x 429	2 x 360	2 x 656	1 x 429	2 x 360	2 x 656			
									R/R	Ft	3'-4"				7'-8"			
									O/A	Ft	6'-5"				10 - 11"			
									WT	LB	942	1032	1465	748	838	1274		
			3.0m (10'-0")				X	3	R/R	Ft	6'-8"				11'-0"			
									O/A	Ft	9'-8"				13'-3"			
									WT	LB	982	1074	1508	793	883	1319		
			4.0m (13'-0")			XX		2+2	R/R	Ft	10'-0"				14'-0"			
									O/A	Ft	13'-0"				16'-4"			
									WT	LB	1039	1129	1565	845	935	1372		
			5.0m (16'-0")			X	X	3+2	R/R	Ft	13'-4"				16'-1"			
									O/A	Ft	16'-4"				18'-4"			
									WT	LB	1084	1171	1607	890	980	1416		
			6.0m (19'-6")				XX	3+3	R/R	Ft	16'-7"				19'-4"			
									O/A	Ft	19'-7"				21'-7"			
									WT	LB	1129	1219	1652	935	1025	1461		
			7.0m (23'-0")		X		XX	3+1+3	R/R	Ft	19'-7"				22'-4"			
									O/A	Ft	22'-7"				24'-7"			
									WT	LB	1179	1269	1704	985	1075	1511		
			8.0m (26'-0")			X	XX	3+2+3	R/R	Ft	23'-0"				25'-1"			
									O/A	Ft	26'-0"				27'-2"			
									WT	LB	1226	1316	1752	1032	1122	1558		
			9.0m (29'-6")				XXX	3+3+3	R/R	Ft	26'-3"				30'-3"			
									O/A	Ft	29'-3"				32'-6"			
									WT	LB	1271	1361	1791	1077	1134	1603		
			10.0m (33'-0")		X		XXX	3+1+3+3	R/R	Ft	29'-3"				7'-8"			
									O/A	Ft	32'-3"				10 - 11"			
									WT	LB	1321	1411	1845	1122	1185	1654		
			11.0m (36'-0")			X	XXX	3+2+3+3	R/R	Ft	32'-7"				35'-4"			
									O/A	Ft	35'-8"				37'-7"			
									WT	LB	1368	1458	1889	1168	1232	1700		
			12.0m (39'-0")				XXXX	3+3+3+3	R/R	Ft	35'-11"				39'-11"			
									O/A	Ft	38'-11"				42'-2"			
									WT	LB	1413	1503	1934	1213	1277	1745		
									WT	LB	425	521	931	425	521	931		

All weights include wire ropes & power cord

TOTAL:



# tracmod *permanent powered platforms*

## tracmod features:

- **Tirak hoists**
- *With reelers*
- *Key controls*
- *Emergency stop at each hoist.*
- *Upper travel limit*
- *Stage tilt switch*
- *Slack cable & overload protection*
- *Fire extinguisher*
- *Guides & rollers*
- *5/16" wire ropes*
- *Optional communication*
- *Optional water tanks*
- *Operating & maintenance manual*
- *110v. power receptacles*
- *Safety harnesses & rope grabs*
- *Manual winches*



TRACTEL's North American SWINGSTAGE Division is a member of the international TRACTEL Group, the world leader in Building Maintenance Systems.

Single-source responsibility is the **TRACTEL** difference: in-house design, fabrication and installation by experienced professionals assures long-term system performance.

The **tracmod** powered platform is suitable for any type of suspension system - from traditional davits and sockets to monorail track with manual or powered trolleys.

**Tractel Ltd.'s Swingstage Division has an office near you:**

### TRACTEL Ltd., Swingstage Division

1615 Warden Avenue,  
Scarborough, Ontario M1R 2T3

Tel: 416 298 8822 Fax: 416 298 1053

### TRACTEL Inc., Swingstage Division - Northeast

[larry@tractelwingstage.com](mailto:larry@tractelwingstage.com)

Tel: 518 864 5615 Fax: 518 864 5616

### TRACTEL Inc., Swingstage Division - West

[allen@tractelwingstage.com](mailto:allen@tractelwingstage.com)

Tel: 415 446 7232 Fax: 415 446 7233

### TRACTEL Inc., Swingstage Division - North Central

[craig@tractelwingstage.com](mailto:craig@tractelwingstage.com)

Tel: 206 542 0300 Fax: 206 542 0530

### TRACTEL Inc., Swingstage Division - Southeast

[tom@tractelwingstage.com](mailto:tom@tractelwingstage.com)

Tel: 770-569-4995 Fax: 770-569-4109

### TRACTEL Inc., Swingstage Division - Southwest

[mike@tractelwingstage.com](mailto:mike@tractelwingstage.com)

Tel: 281 392 4900 Fax: 281 392 4901



**DESCRIPTION**

Standard TRACMOD modular components may be assembled with various lengths and suspension locations. The following chart presents typical platform specifications.

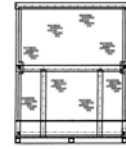

1m (3') section

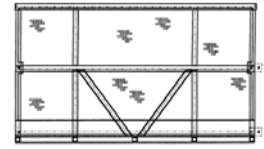

2m (6'-6") section

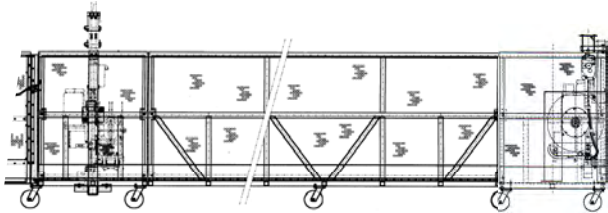

Powered Intermediate Section

Powered End Section

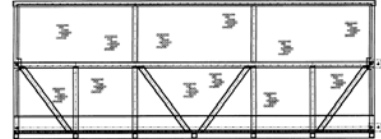

3m (10') section

Platform Assemblies						Assembly Specifications								
Nom. Lg.	ft m	Single Module				modular sections (m) used in platform assembly	Min. R/R = 0.5 O/A	Distance between ropes.....R/R Platform Overall Length.....O/A Platform Total Weight.....WT						
		1'-9" 0.5	3'-0" 1.0	6'-5" 2.0	9'-8" 3.0			Powered Intermediate			Powered End Section			
Weight lbs.		13.5	50.5	97	142		1	2	2	1	2	2		
<b>P L A T F O R M  N O M I N A L  L E N G T H S</b>	2.0m (6'-6")			X		2	R/R ft.	3'-4"			7'-8"			
							O/A ft.	6'-5"			10'-11"			
							WT lbs.	942	1032	1465	748	838	1274	
	3.0m (10'-0")					X	3	R/R ft.	6'-8"			11'-0"		
								O/A ft.	9'-8"			13'-3"		
								WT lbs.	982	1074	1508	793	883	1319
	4.0m (13'-0")				XX		2 + 2	R/R ft.	10'-0"			14'-0"		
								O/A ft.	13'-0"			16'-4"		
								WT lbs.	1039	1129	1565	845	935	1372
	5.0m (16'-0")				X	X	3 + 2	R/R ft.	13'-4"			16'-1"		
								O/A ft.	16'-4"			18'-4"		
								WT lbs.	1084	1171	1607	890	980	1416
6.0m (19'-6")					XX	3 + 3	R/R ft.	16'-7"			19'-4"			
							O/A ft.	19'-7"			21'-7"			
							WT lbs.	1129	1219	1652	935	1025	1461	
7.0m (23'-0")			X		XX	3 + 1 + 3	R/R ft.	19'-7"			22'-4"			
							O/A ft.	22'-7"			24'-7"			
							WT lbs.	1179	1269	1704	985	1075	1511	
8.0m (26'-0")				X	XX	3 + 2 + 3	R/R ft.	23'-0"			25'-1"			
							O/A ft.	26'-0"			27'-2"			
							WT lbs.	1226	1316	1752	1032	1122	1558	
9.0m (29'-6")					XXX	3 + 3 + 3	R/R ft.	26'-3"			30'-3"			
							O/A ft.	29'-3"			32'-6"			
							WT lbs.	1271	1361	1791	1077	1134	1603	
10.0m (33'-0")			X		XXX	3 + 1 + 3 + 3	R/R ft.	29'-3"			7'-8"			
							O/A ft.	32'-3"			10'-11"			
							WT lbs.	1321	1411	1845	1122	1185	1654	
11.0m (36'-0")				X	XXX	3 + 2 + 3 + 3	R/R ft.	32'-7"			35'-4"			
							O/A ft.	35'-8"			37'-7"			
							WT lbs.	1368	1458	1889	1168	1232	1700	
12.0m (39'-0")					XXXX	3 + 3 + 3 + 3	R/R ft.	35'-11"			39'-11"			
							O/A ft.	38'-11"			42'-2"			
							WT lbs.	1413	1503	1934	1213	1277	1745	

wire rope & power cord only: WT lbs. 425 521 931 425 521 931

All weights include wire ropes & power cord

**Description**

Pull under bracket is used when a building has an overhang, to gain access to the windows below. A monorail track and suspension trolley are used to pull the stage under the overhang to gain access to the remainder of the building.

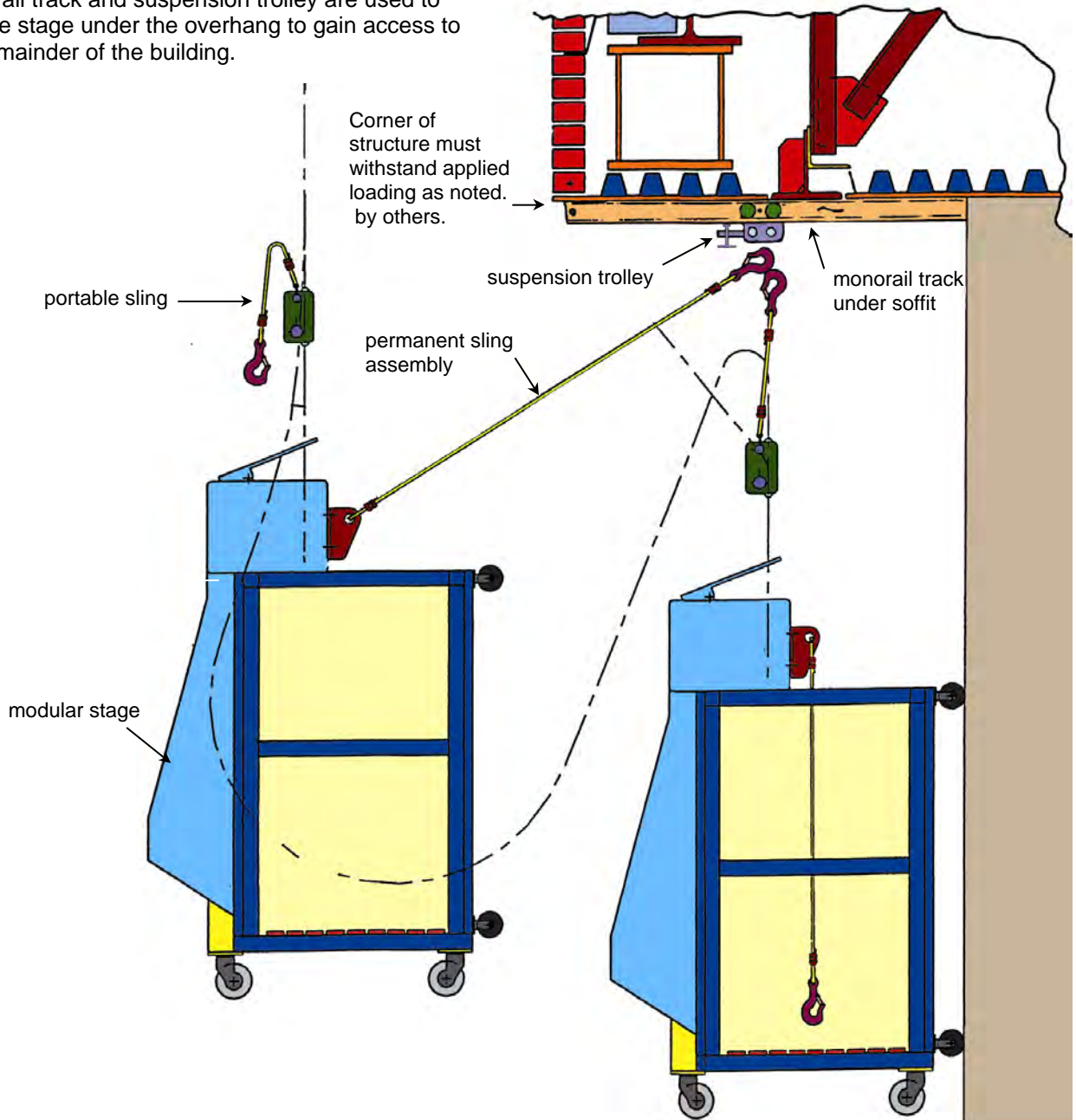



**Application:** Two Man TRACMOD Powered Platform

**Customer:** International Broadcasting Bureau,  
**Site:** Voice of America,  
Washington D.C. - ref: 9866

**Equipment:** DC Powered Two Man Platform  
Suspension & Secondary wire rope

**Description of Application:**

The International Broadcasting Bureau of the United States required a permanent maintenance platform to access the Voice of America 'curtain' antenna.

The antenna is part of an international system used to broadcast HF frequencies around the world. This particular site directs programs such as 'Radio Free Europe' to Europe and Africa.

The unit is suspended from the structures cantenaries, and provides access to the intricate parts of this site.

**Technical Data:**

Hoist Type: TIRAK X500P, dual line, with dual  
reelers  
Power supply: 24 VDC – battery powered  
Working speed: 30 ft./min.  
Working time: 1 hour continuous operation before  
recharge  
Max. operators: 2  
Traverse system: manual  
Suspension: Primary & secondary anti-spin wire rope  
Max. work height: 450 ft.

## product information

## access references TRACMOD POWERED PLATFORMS

ref.: M 4767  
rev. no.:  
date: 10/98  
page: 1/1

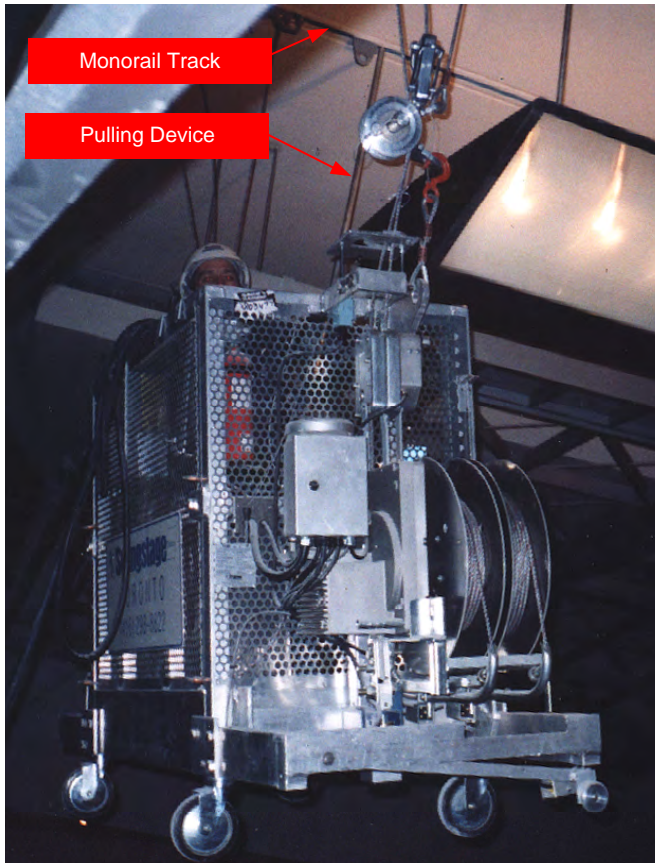

**Application:** TRACMOD Powered Platform & Interior Monorail

**Site:** Ronald Reagan Building & International Trade Center – Auditorium Interior  
Federal Triangle  
1300 Pennsylvania Avenue  
Washington, D.C. - ref.: 9925

**Customer:** A.J. Contracting Inc.

**Equipment:** 120 ft. (37m) – Inclined monorail track  
2 – Friction drive trolleys & pulling device  
1 – 6.5 ft. (2 m) TRACMOD powered platform

### Technical Data:

TRACMOD powered platform:

Maximum suspension height: **100 ft. (30 m)**  
Suspension type: **dual-line**  
Hoist type: **TIRAK XE500P, traction**  
Platform load capacity: **500 lbs. (225 kg)**  
Working speed: **30 ft./min. (9 m/min.)**  
Number of operators required: **2**  
Traversing system: **manual**

Monorail track:

Track type: **'C' channel, straight**  
Track mounting: **bolted, flush to ceiling**  
Track load capacity: **700 lbs. (315 kg)**  
Track support: **spreader bar across 3 beams**  
Trolleys: **friction type for inclined track**

### Description of the application:

The new Federal Triangle, owned by the U.S. Government Services Authority, was designed by architects Pei, Cobb, Fred & Partners.

The Ronald Reagan Building Auditorium houses a theater that required maintenance access to lighting suspended from an inclined ceiling.

Tractel Ltd. supplied monorail track along both sides of the fixtures, mounted flush to the ceiling. The load of the system required that the monorail be supported from three structural members above the ceiling level.

The TRACMOD powered platform is ground rigged from special friction trolleys designed to be stable along the slightly inclined monorail.

When not in use, the platform is de-rigged and stored out of sight.



*Tractel provided many different access systems on this project, including a SENIOR Roofcar and special Rolling Ladders (see Product Information sheets M-4780 & M-4781).*



**product  
information**

**access reference  
Powered Platform**

ref.: **M4811**  
rev. no.: **0**  
date: **02/09**  
page: **1/1**



**Application:** Powered Platform

**Site:** 601, California Street, Suite 100  
San Francisco, CA 94108 - ref. 8274

**Customer:** HINES

**Equipment:** 23' Powered Platform designed for a  
350' service height.



**product information**

**access reference**  
Davit System & Powered Platform

ref.: M4817  
rev. no.: 0  
date: 02/09  
page: 1/1



**Application:** Davits and Powered Platform  
**Site:** AG Spanos Building - ref. 8424  
**Customer:** HMHB Inc.  
**Equipment:** Davit System and Powered Platform



**product  
information**

**access reference**  
**Davit System and Powered Platform**

ref.: **M4819**  
rev. no.: **0**  
date: **02/09**  
page: **1/2**



**Application:** Davit System and Platform

**Site:** 71 Stevenson Street,  
San Francisco, CA 94105

**Customer:** Cushman & Wakefield - ref. 8496

**Equipment:** Davit System, Monorail System,  
Powered System



**product  
information**

**access reference  
Davit System and Powered Platform**

ref.: **M4819**  
rev. no.: **0**  
date: **02/09**  
page: **2/2**



**Application:** Davit System

**Site:** 71 Stevenson Street,  
San Francisco, CA 94105

**Customer:** Cushman & Wakefield



**product  
information**

**access reference  
Davit System**

ref.: **M4821**  
rev. no.: **0**  
date: **02/09**  
page: **1/1**



**Application:** Blue Cross - Blue Shield - Finger lakes

**Site:** 300 Trolley Boulevard  
Rochester  
New York, 14606

- ref. 9957

**Customer:** Le Chase Construction

**Architect:** Fox & Fowle Architects P.C.  
Nick Tocheff

**Equipment:** Davit system

