



Enclose™ Moveable Walls

Enclose offers the adaptability of moveable walls, yet provides a high-end aesthetic and a feeling of permanence. With the ability to hang mountable components and with features like removable skins and frameless glass doors, Enclose can meet any design challenge. Offering superior benefits, the acoustics of Enclose walls rival that of traditional dry wall. Enclose walls adjust to the building with consistent detailing to ceilings, floors and architectural walls. For even greater design freedom, Enclose is designed to share materials, components and dimension logic with the Haworth Compose™ Open Plan Panel System.

Available floor to ceiling
or partial height, from
80" - 126"

Designed to
integrate with wall-
mounted Adaptable
Components as
well as Compose™
System

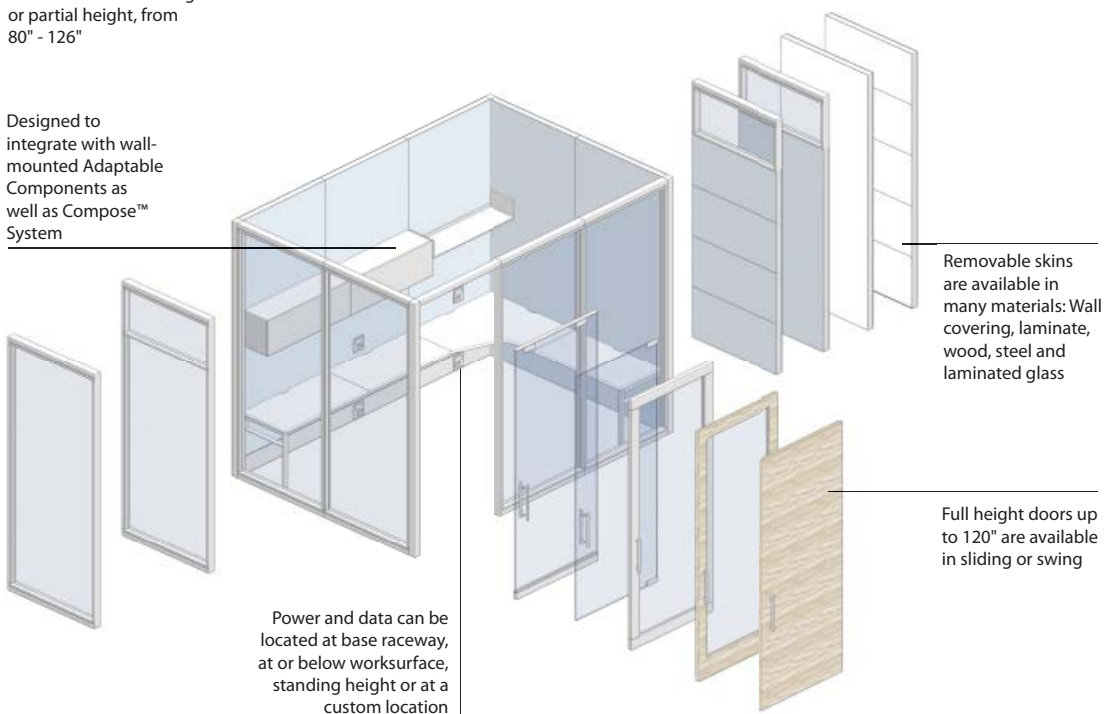

Choose from three corner
options: frameless glass,
closed or open. All frames
are available in
rectilinear aluminum or wood.

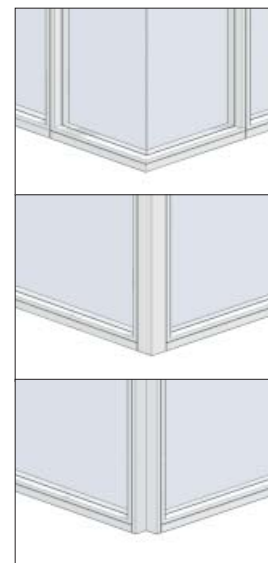



LifeSPACE® Moveable Walls

A scalable alternative to traditional construction, LifeSPACE gives you everything you need to create a distinctive, efficient design. Glass, wood veneer, powder-coated metal and a variety of vinyl and fabric choices maximize design freedom. Single- and double-door options include solid wood, powder-coated metal, with clear, patterned, or diffused glazing. Even the muntin locations can be defined to your specifications. Plus, LifeSPACE full-height wood doors and truly moveable curved walls give you greater options for achieving the finished space you envision.

LifeSPACE 225

- A 2.25" platform
- Includes architectural glass, solid and combination panels
- Standard 3/4" postcap or 1/4" slimline reveal on solid walls

Available options

- Slimline reveal in wall covering or wood
- Standard postcap in wall covering or wood
- Rectilinear center mount in wood or aluminum

LifeSPACE 375

- A 3.75" platform
- Architectural glass fronts can be used with LifeSPACE 225 or conventional construction
- 1/4" slimline reveal

Available options

- Elliptical center mount in wood or aluminium
- Rectilinear flush mount in aluminum
- Rectilinear center mount in wood

